



**Loba.**  
On Top!



## Dustless Recoating System – from the specialist

### **LOBA® WS 2K Contact** Waterborne system for wood and cork floors

Developed with global leaders in UV finishing technology and tested successfully on over 100 brands.

- No sanding necessary  
no special machines – no dust
- VOC compliant – LOBA® WS 2K Supra  
qualifies for LEED credits EQ 4.2
- Great for coating of hand scraped  
and distressed floors
- 4 simple steps, the C<sup>4</sup> System

**See reverse side for more information.**

### **LOBA – the surface specialist for wood and cork flooring**

Dirk Kesberg –  
Underwater  
Repair Specialist



# The C<sup>4</sup> System



## C<sup>1</sup>: Certify

To evaluate the success on your floor, perform a coin test and cross cut test before recoating. The final adhesion of the topcoat is reached after 3 days.



Sometimes older floors may have been treated with wax or might be contaminated with other substances. This test evaluates adhesion.

Coin test

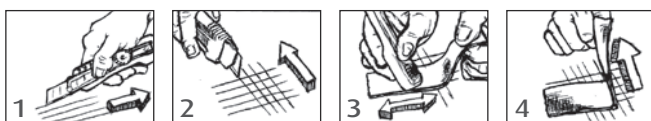

Cross cut test

## C<sup>2</sup>: Clean

For additional coats immediately after installation, clean the floor with LOBA<sup>®</sup> Hardwood Floor Cleaner. For recoating an old, worn floor we recommend a deep cleaning with LOBA<sup>®</sup> Remover, followed by LOBA<sup>®</sup> Hardwood Floor Cleaner.



LOBA<sup>®</sup> Hardwood Floor Cleaner

## Deep Cleaning:

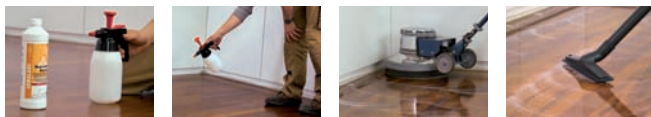

- Apply LOBA<sup>®</sup> Remover diluted in water (1:5)
- Buff the surface with a green (or maroon) pad
- Use a wet/dry vacuum to take off the old wax and grease
- Mop the floor with LOBA<sup>®</sup> Hardwood Floor Cleaner

## C<sup>3</sup>: Contact

Apply LOBA<sup>®</sup> WS 2K Contact after the floor is dry and free of any dust.



The application of LOBA<sup>®</sup> WS 2K Contact adhesion promoter is very simple. Just mix component A and B together and apply a thin coat of LOBA<sup>®</sup> WS 2K Contact over the whole floor using a trim pad or heavy T-bar applicator. The coverage rate of LOBA<sup>®</sup> WS 2K Contact is approximately 600–700 sq ft per quart. Allow to dry for 2 hours before finishing with LOBA<sup>®</sup> WS 2K Supra. LOBA<sup>®</sup> WS 2K Supra must be applied within 24 hours of the LOBA<sup>®</sup> WS 2K Contact drying.

## C<sup>4</sup>: Coat

LOBA<sup>®</sup> WS 2K Supra is formulated for commercial high traffic floors and the only finish that works in combination with LOBA<sup>®</sup> WS 2K Contact.

LOBA<sup>®</sup> WS 2K Supra is available in a variety of beautiful sheens and qualifies for LEED credits as an EQ 4.2 low emission coating. Apply one coat of LOBA<sup>®</sup> WS 2K Supra with a roller, brush or T-bar applicator. Apply using 400–500 sq ft per gallon coverage. Use floor carefully for the first 5 days. Maintain with LOBA<sup>®</sup> Hardwood Floor Cleaner.



**LoBa.**  
On Top!

Please feel free to contact us for additional information, application instructions and system recommendations.

LoBa-Wakol LLC 1604 N. Main St. | Kannapolis, NC 28081 | United States | Phone: (800) 230-6456  
Fax: (704) 932-3041 | E-Mail: [info@loba-wakol.com](mailto:info@loba-wakol.com) | [www.loba-wakol.com](http://www.loba-wakol.com)